

- EXCELLENT ACOUSTIC PROPERTIES •
- CHOICE OF DRIVER UNITS •
- WATER- AND DUST PROTECTED TO IP 65 •
- VERSATILE MOUNTING BRACKET •
- UV LIGHT RESISTANT •



LBC 3403/14



LBC 3404/14



LBC 3405/14



LBC 3406/14

LBC 3403/14, LBC 3404/14, LBC 3405/14, LBC 3406/14

HORN LOUDSPEAKERS

The Philips professional horn loudspeaker system allows a range of different driver units to be installed into the various horns. The system includes four horns, three circular types with aperture diameters of 255, 380 and 510 mm and a rectangular model with an opening measuring 390 x 235 mm.

The drivers (ordered separately) are mounted inside the horn, and the connection cable is fed out through a cable gland in the cover plate. This makes the loudspeaker horn/driver unit splash-waterproof, and therefore ideal for outdoor sound reinforcement applications. Three driver units are available, a 15 W, 30 W and a 50 W type for 100V lines only.

Construction

In the construction of the horns, maximum use has been made of standard parts in a modular concept. The screw thread for securing the driver units is a standard

1 3/8-inch thread (1 3/8"- 18 UNEF-2A). The shape of the cover plate gives the horns a distinctive and easily recognizable style.

The cover plates have provision on their inside face for mounting the optional loudspeaker surveillance board. Note that the 50 W driver cannot be used in horns where the loudspeaker surveillance board is installed.

They are made from high-impact Polystyrene (PS) material combining strength with low weight. This rugged material is resistant to ultraviolet light, aggressive environments and most industrial chemicals. The horns (incl. brackets) are finished in light grey. The sturdy steel mounting bracket allows easy mounting and directing of the horn.

SPECIFICATIONS

LBC 3403/I4, LBC 3404/I4, LBC 3405/I4, LBC 3406/I4

HORN LOUDSPEAKERS

TECHNICAL PERFORMANCE DATA ACC. TO IEC 268-5

	LBC 3403/I4	LBC 3404/I4	LBC 3405/I4	LBC 3406/I4
Sound pressure level at rated power/1 W (at 1 kHz, 1 m)				
with driver LBN 9000/00	121/109 dB (SPL)	124/112 dB (SPL)	125/113 dB (SPL)	122/110 dB (SPL)
with driver LBN 9001/00	125/110 dB (SPL)	128/113 dB (SPL)	129/114 dB (SPL)	127/112 dB (SPL)
with driver LBN 9003/00	127/110 dB (SPL)	130/113 dB (SPL)	132/115 dB (SPL)	129/112 dB (SPL)
Effective frequency range (-10 dB)				
with driver LBN 9000/00	400 Hz to 7 kHz	400 Hz to 9 kHz	400 Hz to 9 kHz	350 Hz to 6.5 kHz
with driver LBN 9001/00	350 Hz to 6 kHz	300 Hz to 8.5 kHz	300 Hz to 8 kHz	300 Hz to 8 kHz
with driver LBN 9003/00	380 Hz to 10 kHz	350 Hz to 10 kHz	350 Hz to 9 kHz	380 Hz to 10 kHz
Opening angle (at 1 kHz/4 kHz, -6 dB)	90°/30°	70°/25°	60°/35°	100°/65° (hor/vert) (1 kHz) 35°/30° (hor/vert) (4 kHz)
Ambient temperature range	-25 to +55 °C (all models)			
Water- and dust protected	acc. to IEC 529 IP 65 (all models)			
Dimensions				
aperture dia.	255 mm	380 mm	510 mm	390 x 235 mm
overall length	355 mm	390 mm	455 mm	390 mm
Colour	light grey (RAL 7035) (all models)			
Weight (excl. driver)	2.4 kg	2.8 kg	3 kg	2.6 kg

Driver units (ordered separately)

Type	Description	Max./Rated power (PHC)
LBN 9000/00	100 V driver	22.5/15 W
LBN 9001/00	100 V driver	45/30 W
LBN 9003/00	100 V driver	75/50 W

Mounting bracket (all models)

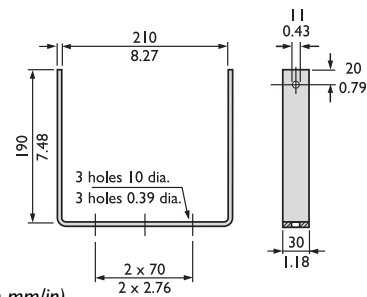

Dimensions (in mm/in)

LBC 3403/I4

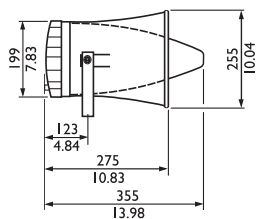

Dimensions (in mm/in)

LBC 3404/I4

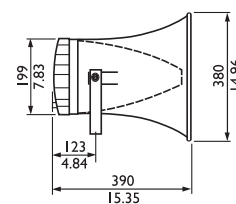

Dimensions (in mm/in)

LBC 3405/I4

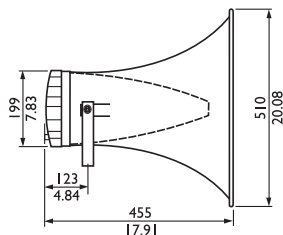

Dimensions (in mm/in)

LBC 3406/I4

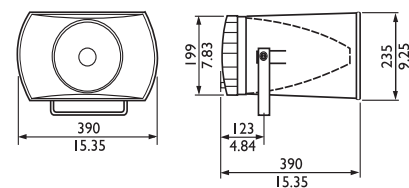

Dimensions (in mm/in)



PHILIPS

Let's make things better.