

- HIGH EFFICIENCY •
- THREE DIFFERENT DRIVER UNITS •
- 15 W, 30 W AND 50 W VERSIONS •
- 1 3/8" SCREW THREAD •
- SIMPLE POWER SETTING •
- COMPLIES WITH INTERNATIONAL INSTALLATION AND SAFETY REGULATIONS •

The Philips professional horn loudspeaker system comprises a range of three high-efficiency driver units that can be installed into one of the compatible circular and rectangular horns (supplied separately without drivers). A standard 1 3/8" screw thread is used for mounting the drivers into horns. All models are treated against corrosion.

**15 W, 30 W and 50 W versions**

The LBN 9000/00 is a 15 W driver unit and the LBN 9001/00 is a 30 W driver unit. Connections to 100 V lines are made using push-on spade terminals. The LBN 9003/00 is a more powerful 50 W model. Connections to 100 V lines are made using screw terminals. Note that the 50 W driver cannot be used



LBN 9000/00



LBN 9001/00



LBN 9003/00

**LBN 9000/00, LBN 9001/00, LBN 9003/00**

DRIVER UNITS

in horns where the loudspeaker surveillance board (LSB) is installed.

**Power tapping**

All driver units include a matching transformer to allow power tapping. See circuit diagram overleaf. This feature also allows impedance matching for different amplifier types.

**Loudspeaker horns**

A range of horns is available for these driver units to allow tailor-made solutions for a variety of sound reinforcement applications. Three circular types (LBC 3403, LBC 3404 and LBC 3405 with diameters of 255, 380 and 510 mm respectively) and one rectangular type (LBC 3406, measuring 380 x 205 mm) are available. They are made from high-impact Polystyrene (PS) material for high strength and

low weight, and are finished in light and dark beige. A sturdy steel mounted bracket is also supplied. See separate datasheet.

**Quality assurance**

All Philips loudspeakers are designed to withstand operating at their rated power for 100 hours in accordance with IEC 268-5 Power Handling Capacity (PHC) standards. Philips has also developed the Simulated Acoustical Feedback Exposure (SAFE) test to demonstrate that they can withstand two times their rated power for short durations. This ensures extra reliability under extreme conditions, leading to higher customer satisfaction, longer operating life, and much less chance of failure or performance deterioration.



**SPECIFICATIONS**

# LBN 9000/00, LBN 9001/00, LBN 9003/00

**DRIVER UNITS**

Technical performance data acc. to IEC 268-5

|   | <b>LBN 9000/00</b>                                     | <b>LBN 9001/00</b>      | <b>LBN 9003/00</b>      |
|---|--|-------------------------|-------------------------|
| <b>Max. power</b>   | 22.5 W   | 45 W                    | 75 W                    |
| <b>Rated power (PHC)</b>  | 15 W<br>(15-10-7.5-5 W)                                | 30 W<br>(30-20-15-10 W) | 50 W<br>(50-40-35-30 W) |
| <b>Sound pressure level at rated power / 1 W (at 1 kHz, 1 m)*</b> | 125/113 dB (SPL)                                       | 129/114 dB (SPL)        | 131/114 dB (SPL)        |
| <b>Rated voltage</b>  | 100 V  | 100 V                   | 100 V                   |
| <b>Rated impedance</b>  | 670 Ω  | 330 Ω                   | 200 Ω                   |
| <b>Voice coil impedance</b>                                       | 8 Ω  | 16 Ω                    | 16 Ω                    |
| <b>Effective frequency range (-10 dB)*</b>                        | 400 Hz to 9 kHz  | 300 Hz to 8 kHz         | 400 Hz to 5 kHz         |
| <b>Screw thread</b>   | exterior thread, 1 3/8", 18 turns per inch (all types) |                         |                         |
| <b>Ambient temperature range</b>                                  | -25 to +55 °C (all types)                              |                         |                         |
| <b>Dimensions (H x max. dia.)</b>                                 | 108 x 92 mm  | 134 x 104 mm            | 162 x 118 mm            |
| <b>Weight (excl. horn)</b>  | 1.3 kg   | 2.1 kg                  | 3.2 kg                  |

\* measured with horn type LBC 3405

**LBN 9000/00**

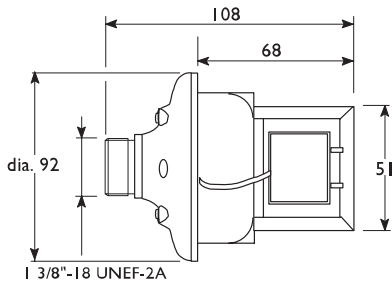

Dimensions (in mm)

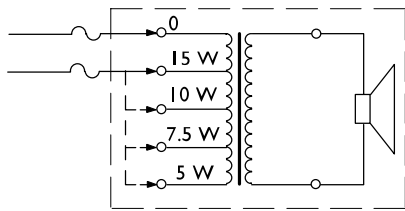

Circuit diagram

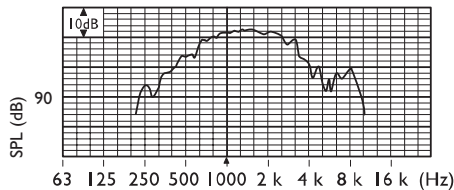

Frequency response

**LBN 9001/00**

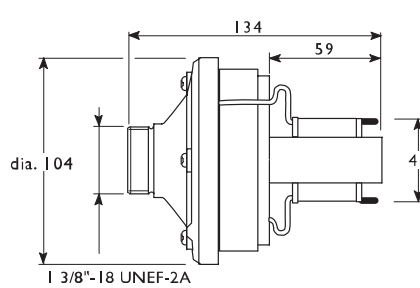

Dimensions (in mm)

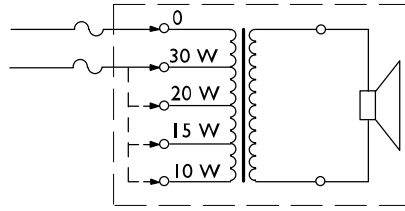

Circuit diagram

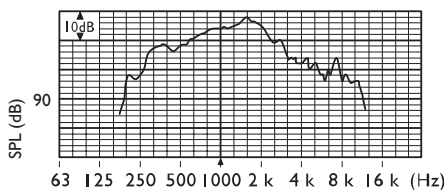

Frequency response

**LBN 9003/00**

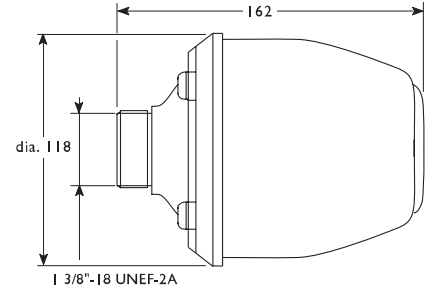

Dimensions (in mm)

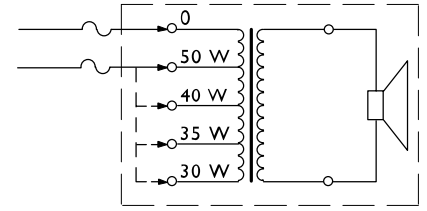

Circuit diagram

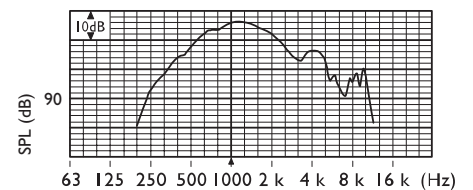

Frequency response



**PHILIPS**

*Let's make things better.*